

SMD T/R Carrier Tape Specifications

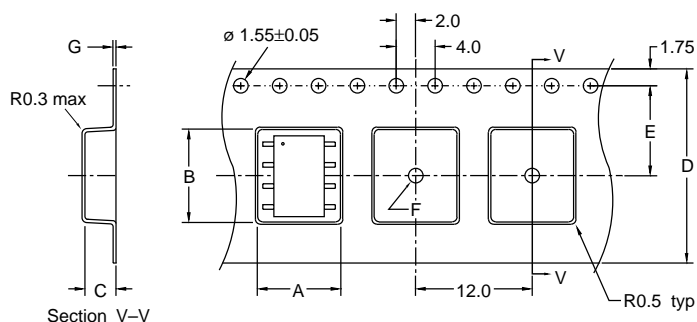

Tape Carrier TC-1



Tape Carrier TC-2

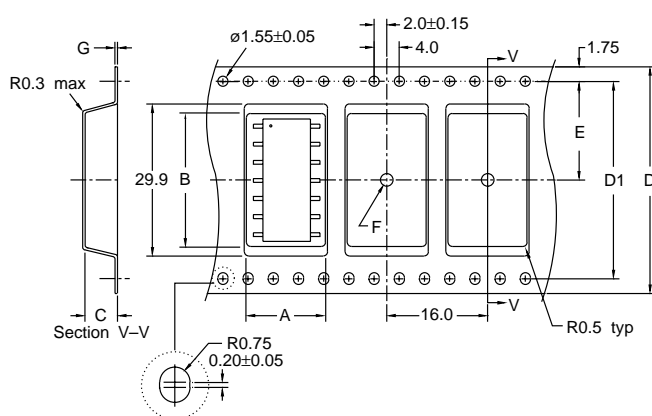

Tape Carrier TC-3

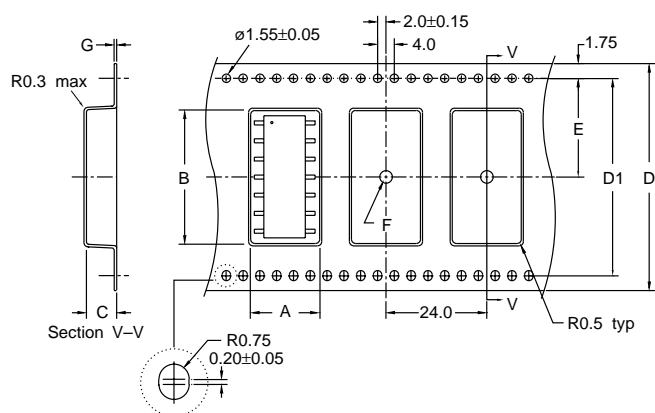

Tape Carrier TC-4

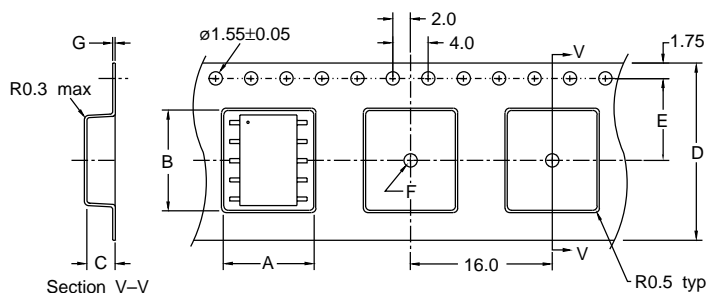

Part Number Suffix	Qty (Reel)	Tape Carrier	Designator / Dimensions (mm, ± 0.2 unless otherwise specified)							
			A	B	C	D	D1	E	F	G
J/J1/J2	1200	TC-1	10.0	13.2	4.3	24.0 \pm 0.3	-	11.5 \pm 0.1	1.5 min	0.35 \pm 0.1
N/N1/N2	1000	TC-1	10.0	13.3	5.6	24.0 \pm 0.3	-	11.5 \pm 0.1	1.5 min	0.35 \pm 0.1
N5	700	TC-1	10.0	13.2	6.8	24.0 \pm 0.3	-	11.5 \pm 0.1	1.5 min	0.35 \pm 0.1
NA	600	TC-4	12.5	9.4	6.9	24.0 \pm 0.3	-	11.5 \pm 0.1	1.5 min	0.35 \pm 0.1
NC	300	TC-3	15.6	17.7	9.1	32.0 \pm 0.3	28.4 \pm 0.1	14.2 \pm 0.1	2.0 min	0.35 \pm 0.1
ND	300	TC-2	13.0	25.9	9.6	44.0 \pm 0.3	40.4 \pm 0.1	20.2 \pm 0.15	2.0 min	0.35 \pm 0.1
NF/NF1	300	TC-3	15.6	12.6	9.1	32.0 \pm 0.3	28.4 \pm 0.1	14.2 \pm 0.1	2.0 min	0.35 \pm 0.1
NL	300	TC-2	13.0	25.9	6.3	44.0 \pm 0.3	40.4 \pm 0.1	20.2 \pm 0.15	2.0 min	0.35 \pm 0.1
NM	600	TC-4	10.0	16.1	6.1	24.0 \pm 0.3	-	11.5 \pm 0.1	1.5 min	0.35 \pm 0.1
NM5	500	TC-4	10.0	16.1	6.8	24.0 \pm 0.3	-	11.5 \pm 0.1	1.5 min	0.35 \pm 0.1
NS	1000	TC-1	9.9	8.6	5.5	16.0 \pm 0.3	-	7.5 \pm 0.1	1.5 min	0.35 \pm 0.1
NT	1000	TC-1	9.9	8.0	5.5	16.0 \pm 0.3	-	7.5 \pm 0.1	1.5 min	0.35 \pm 0.1
NX	300	TC-3	16.2	28.4	6.2	44.0 \pm 0.3	40.4 \pm 0.1	20.2 \pm 0.15	2.0 min	0.35 \pm 0.1
NZ	400	TC-3	16.2	18.2	6.2	32.0 \pm 0.3	28.4 \pm 0.1	14.2 \pm 0.1	2.0 min	0.35 \pm 0.1
P/P1/P2	2000	TC-1	10.0	13.3	2.5	24.0 \pm 0.3	-	11.5 \pm 0.1	1.5 min	0.35 \pm 0.1